

RYGIEL DACHOWY – ELEMENTY III

1:10

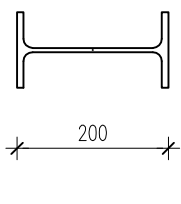
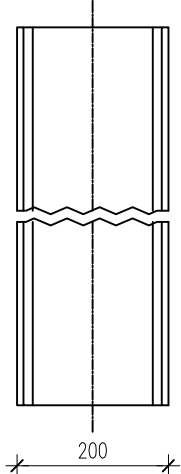

Poz. 165 Widok z przodu (Sc1:10)

IPE 200 (2 x)

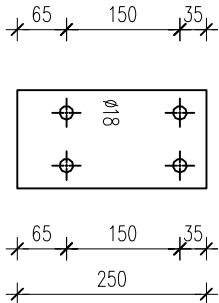

Poz. 170 Sc1:10

BL. 8x130x250 (18 x)

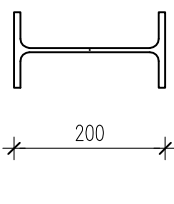
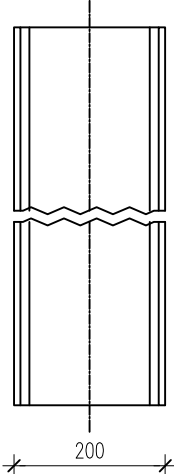

Poz. 166 Widok z przodu (Sc1:10)

IPE 200 (2 x)

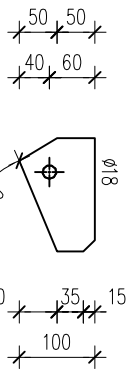

Poz. 171 Sc1:10

BL. 8x100x150 (32 x)

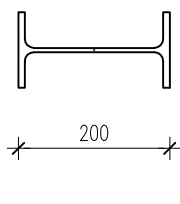
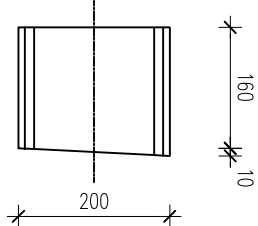

Widok z lewej

Poz. 167 Widok z przodu (Sc1:10)

IPE 200 (8 x)

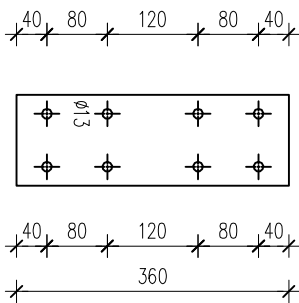
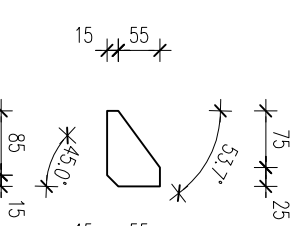

Poz. 168 Sc1:10

BL. 8x70x100 (8 x)

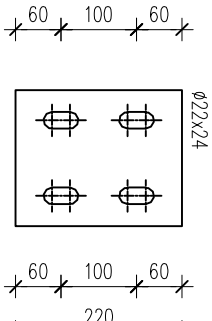

Poz. 169 Sc1:10

BL. 16x120x360 (4 x)

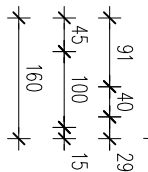
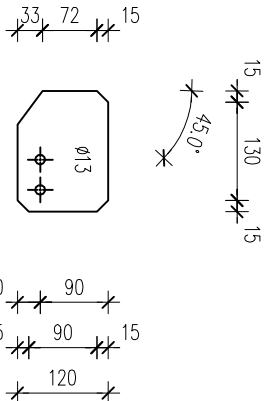

Poz. 172 Sc1:10

BL. 8x120x160 (4 x)

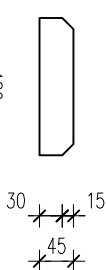
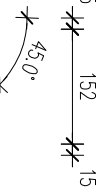

Poz. 173 Sc1:10

BL. 8x120x160 (4 x)

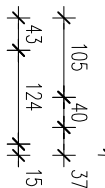
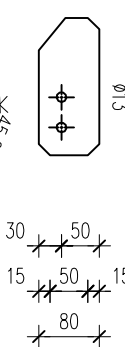
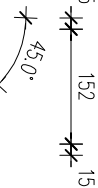

Poz. 174 Sc1:10

BL. 8x180x220 (8 x)

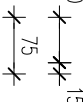
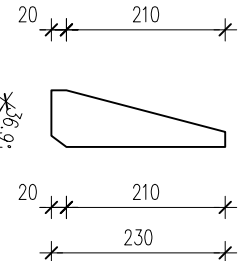

Poz. 175 Sc1:10

BL. 8x45x182 (16 x)

SZT.	POZ.	NAMNA	DLUGOŚĆ	WAGA	STAL
2	165	PE 200	5148	115.5	S355J2
2	166	PE 200	12000	269.3	S355J2
8	167	IPE 200	170	3.8	S355J2
8	168	BL. 8x70x100	100	0.3	S355J2
4	169	BL. 16x120x360	120	5.4	S355J2
18	170	BL. 8x130x250	130	2.0	S355J2
32	171	BL. 8x100x150	150	0.7	S355J2
4	172	BL. 8x120x160	160	1.1	S355J2
4	173	BL. 8x120x160	160	1.1	S355J2
8	174	BL. 16x180x220	180	5.0	S355J2
16	175	BL. 8x45x182	182	0.5	S355J2
12	176	BL. 8x80x182	182	0.8	S355J2
16	177	BL. 6x75x230	230	0.5	S355J2
16		M12x65 PN-EN ISO4014	65	0.0	8.8

Catkowita masz. 960 kg

ATM "ATM" Krzysztof Mikoszewicz – usługi budowlane
ul. Skłodowska 12 lok. 107, 15–399 Białystok
tel. 85 742 40 08 wew.20, atmpojekt@interia.pl

projekt:
ZESPÓŁ BUDYŃKÓW DO PRZEPROWADZANIA
KONTROLI FITOSANITARNEJ
DZIAŁKA NR GEOD. 271/6 W KUŹNICY

nr rys.	rysunek:	skala:
Ks-33	RYGIEL DACHOWY – ELEMENTY III	1:10
opracował:	mgr inż. M. Maliszewski	podpis:
opracował:	mgr inż. H. Maliszewska	podpis:
współpraca:	nr uprawnień:	podpis: